

TECHNICAL INFORMATION - HYDRACLAW

- Powerful - 5 tonne capacity on head or toe
- High Lift – 178mm
- Low Clearance – 41mm
- Vertical & Horizontal Operation
- Robust Ferrous Construction – suitable for use underground
- Stable – substantial base offers stability under load

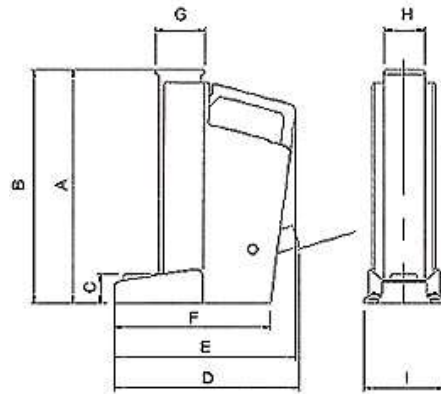

Capacity (tonne)	5
Order Code	9501W
Dimensions (mm)	
A	327
B	505
C	41
D	258
E	255
F	219
G	63.5
H	57
I	114.3
Specifications	
Lever Weight	3.63 kgs
Jack Weight (inc. Oil)	18kgs
Lift per Stroke	5.5mm
Max. Handle Effort	45 kgf

All prices quoted are excluding VAT